

Terminales

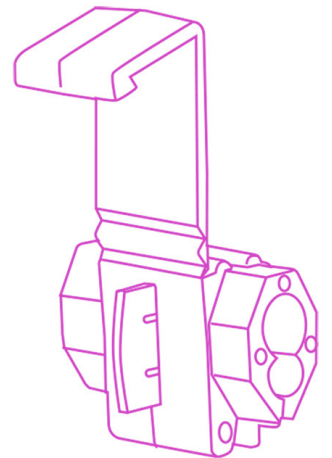

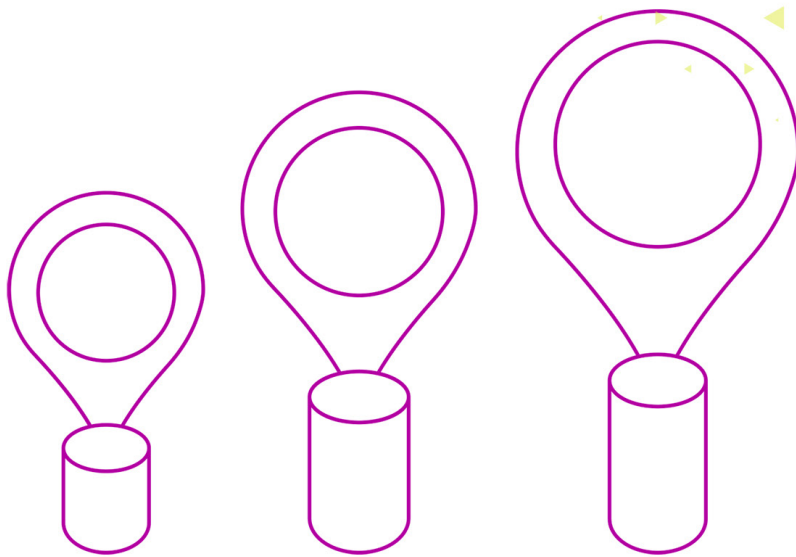

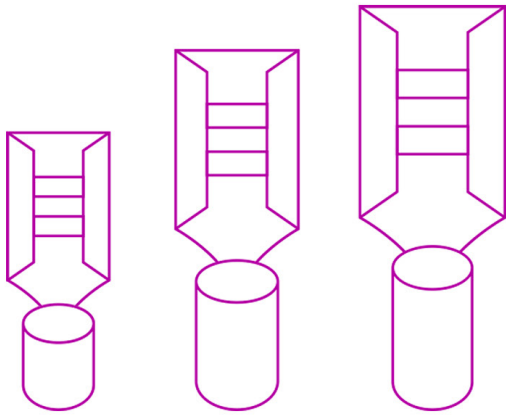

Terminales







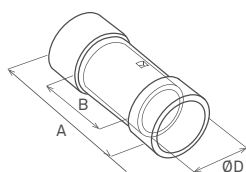

TERMINALES

Conector a tope aislado (PVC)

Código	Color	Calibre AWG	Dimensiones (mm)			Piezas
			A	B	ØD	
AE05590		22 - 16	27	15	6.6	100
AE20562		16 - 14	26.5	15	4.8	100
AE20570		12 - 10	25.8	15	4.3	100



Capuchón

Código	Color	Calibre AWG	Descripción	Dimensiones (mm)			Piezas
				A	B	ØD	
AE00010		18	Roscables (PVC)	14.2	5.3	8.4	100
AE00015		14	Roscables (PVC)	17.8	5.3	10.1	100
AE00020		12	Roscables (PVC)	22	7.9	11.2	100
AE00025		10	Roscables (PVC)	24.2	6.8	14.8	100
AE00030		14	Ponchables	24.5	—	10.6	100
AE00035		10	Ponchables	26.5	—	12.4	100
AEJO-2		12 - 8	Roscables con ceja	25.6	8.5	13.9	100
AEJO-3		18 - 14	Roscables con ceja	26.8	10.5	14.9	100
AEJO-4		22 - 18	Roscables con ceja	26.9	11.5	15.5	100

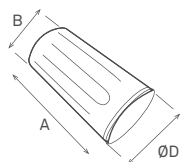

Terminal tipo almeja

Código	Color	Calibre	Dimensiones (mm)			Piezas
			A	B	C	
AECW-1-25	●	22 - 16	9.7	9.7	20.5	50
AECW-2	●	16 - 14	9.7	9.7	20.5	50
AECW-5-5	●	12 - 10	13.7	13.7	24.5	50

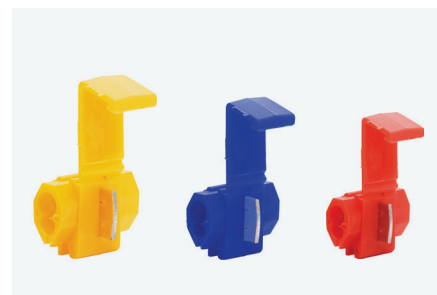
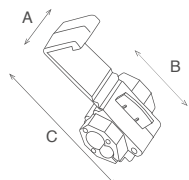

Conector a tope sin aislar

Código	Calibre	Dimensiones (mm)			Piezas
		A	ØD	Ød2	
AE31818	22 - 16	15	3.3	1.7	100
AE31819	16 - 14	15	3.8	2.4	100
AE32151	12 - 10	15	5.5	3.6	100

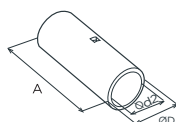

Terminal tipo espada sin aislar

Código	Calibre	Tamaño de orificio	Dimensiones (mm)					Piezas
			A	B	C	ØD	Ød2	
AE36195	22 - 16	1/8	16	4.5	5.7	3.4	3.2	100
AE51271	22 - 16	5/32	16	4.5	6.4	3.4	4.3	100
AE34118	22 - 16	3/16	16	4.5	8	3.4	5.3	100
AE22996	16 - 14	1/8	16	4.5	5.7	4	3.2	100
AE36880	16 - 14	5/32	16	4.5	6.4	4	4.3	100
AE34129	16 - 14	3/16	16	4.5	8	4	5.3	100
AE32995	12 - 10	5/32	18	6.3	8	5	4.3	100
AE35495	12 - 10	3/16	18	6.3	8	5.3	5.3	100

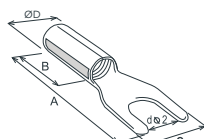



Terminal tipo ojo sin aislar

Código	Calibre	Tamaño de orificio (pulg)	Dimensiones (mm)					Piezas
	AWG		A	B	C	ØD	Ød2	
AE33456	12 - 10	1/8	15.7	6.8	7.2	3.2	3.7	100
AE32994	12 - 10	5/32	20	6.8	9.5	3.2	4.3	100
AE33457	12 - 10	3/16	20	6.8	9.5	3.2	5.3	100
AE23138	12 - 10	1/4	21.4	6.8	12	3.2	6.4	100
AE22457	12 - 10	5/16	28	6.8	15	3.2	8.4	100
AE33220	12 - 10	3/8	28	6.8	15	3.2	10.5	100
AE32996	8	5/32	19.8	6.8	9.5	3.5	4.3	100
AE33460	8	3/16	19.8	6.8	9.5	3.5	5.3	100
AE33461	8	1/4	25.8	6.8	12	3.5	6.4	100
AE33462	8	5/16	28	6.8	15	3.5	8.4	100
AE33463	8	3/8	28	6.8	15	3.5	10.5	100
AE33464	6	3/16	27.5	10	12	5.8	5.3	100
AE33465	6	1/4	27.5	10	12	5.8	6.4	100
AE33466	6	5/16	32.5	10	16	5.8	8.4	100
AE33467	6	3/8	32.5	10	16	5.8	10.5	100
AE33469	4	1/4	33.7	12	16.5	7.7	6.4	100
AE33470	4	5/16	33.7	12	16.5	7.7	8.4	100
AE33471	4	3/8	33.7	12	16.5	7.7	10.5	100
AE35184	2	3/8	43	14	22	9.4	10.5	100
AE35185	2	1/2	43	14	22	9.4	13	100
AE36915	1/0	1/4	47	18	22	11.4	6.4	100
AE36916	1/0	5/16	47	18	22	11.4	8.4	100
AE36917	1/0	3/8	47	18	22	11.4	10.5	100
AE36918	1/0	7/16	49	18	22	11.4	11.5	100
AE36919	1/0	1/2	49	18	22	11.4	13	100
AE36921	2/0	1/4	50.5	19	27	13.5	6.4	100
AE36922	2/0	5/16	50.5	19	27	13.5	8.4	100
AE36923	2/0	3/8	50.5	19	27	13.5	10.5	100
AE21872	2/0	7/16	52.5	19	27	13.5	11.5	100
AE36925	2/0	1/2	52.5	19	27	13.5	13	100

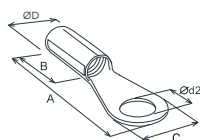

Terminal tipo ojo sin aislar

Código	Calibre AWG	Tamaño de orificio (pulg)	Dimensiones (mm)					Piezas
			A	B	C	ØD	Ød2	
AE34107	22 - 16	1/8	11.5	4.5	5.5	1.7	3.2	100
AE34108	22 - 16	5/32	14.4	4.5	6.6	1.7	4.3	100
AE34109	22 - 16	3/16	15.8	4.5	8	1.7	5.3	100
AE34113	22 - 16	1/4	21.7	4.5	11.6	1.7	6.4	100
AE34114	22 - 16	5/16	21.7	4.5	11.6	1.7	8.4	100
AE34121	16 - 14	1/8	15.8	4.8	8.5	2.3	3.2	100
AE34122	16 - 14	3/32	16.8	4.8	8.5	2.3	4.3	100
AE34123	16 - 14	3/16	16.8	4.8	9.5	2.3	5.3	100
AE34124	16 - 14	1/4	21.8	4.8	12	2.3	6.4	100
AE34125	16 - 14	5/16	21.8	4.8	12	2.3	8.4	100
AE20266	3/0	5/16	52.5	20	27	14.5	8.4	100
AE36927	3/0	3/8	52.5	20	27	14.5	10.5	100
AE21876	3/0	7/16	52.5	20	27	14.5	11.5	100
AE36929	3/0	1/2	52.5	20	27	14.5	13	100
AE36930	3/0	5/8	58	20	32	14.5	17	100
AE22223	3/0	3/4	58	20	32	14.5	19	100
AE21878	4/0	3/8	55	21	28.5	16.4	10.5	100
AE21879	4/0	7/16	55	21	28.5	16.4	11.5	100
AE21880	4/0	1/2	69	21	32	16.4	13	100
AE36935	4/0	5/8	69	21	32	16.4	17	100
AE22228	4/0	3/4	69	21	32	16.4	19	100

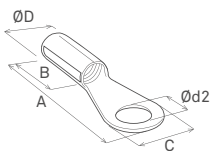



Terminal tipo ojo aislada (PVC)

Código	Color	Calibre	Tamaño de orificio	Dimensiones (mm)					Piezas
				A	B	C	E	Ød2	
		AWG	(pulg)						
AE34144	●	22 - 16	1/8	18	10.7	5.5	4.3	3.2	100
AE34145	●	22 - 16	5/32	22.3	10.7	8	7.3	4.3	100
AE34146	●	22 - 16	3/16	22.3	10.7	8	7.3	5.3	100
AE34150	●	22 - 16	1/4	28.2	10.7	11.6	11.4	6.4	100
AE34151	●	22 - 16	5/16	28.2	10.7	11.6	11.4	8.4	100
AE34159*	●	16 - 14	1/8	23	10.7	8.5	7.75	3.2	100
AE34160*	●	16 - 14	5/32	23	10.7	8.5	7.75	4.3	100
AE34161*	●	16 - 14	3/16	23	10.7	9.5	7.25	5.3	100
AE34162*	●	16 - 14	1/4	28	10.7	12	11	6.4	100
AE34163*	●	16 - 14	5/16	28	10.7	12	11	8.4	100
AE34853	●	12 - 10	5/32	26.7	13.7	9.5	8.25	4.3	100
AE34854	●	12 - 10	3/16	26.7	13.7	9.5	8.25	5.3	100
AE50242	●	12 - 10	1/4	32.7	13.7	12	13	6.4	100
AE50181	●	12 - 10	5/16	34.9	13.7	15	13.7	8.4	100
AE34173	●	12 - 10	3/8	34.9	13.7	15	13.7	10.5	100
AE34837	●	12 - 10	1/2	35	15	18	16	13	100



* Cuentan con certificación UL

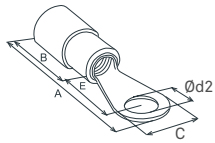

Terminal tipo espada aislada (PVC)

Código	Color	Calibre	Tamaño de orificio	Dimensiones (mm)					Piezas
				A	B	C	E	Ød2	
AE20665	●	22 - 16	1/8	22.5	10.7	5.7	4.3	3.2	100
AE51292	●	22 - 16	5/32	22.5	10.7	6.4	7.3	4.3	100
AE34156	●	22 - 16	3/16	22.5	10.7	8.0	7.3	5.3	100
AE22994	●	16 - 14	1/8	22.5	10.7	5.7	11.4	3.2	100
AE26741	●	16 - 14	5/32	22.5	10.7	6.4	11.4	4.3	100
AE34167	●	16 - 14	3/16	22.5	10.7	8.0	7.75	5.3	100
AE34857	●	12 - 10	5/32	26.7	13.7	9.0	7.75	5.3	100
AE34176	●	12 - 10	3/16	26.7	13.7	8.2	7.25	4.3	100

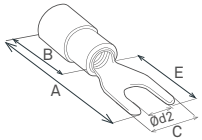

Terminal hembra aislada (PVC)

Código	Color	Calibre	Serie	Dimensiones (mm)				Piezas
				A	B	C	ØD	
AE55125	●	22 - 16	.187	21.5	10	7.8	1.8	100
AE51231	●	22 - 16	.250	23.5	10	9.6	1.8	100
AE55122	●	16 - 14	.187	21.5	10	7.8	2.3	100
AE55095	●	16 - 14	.250	23.5	10	9.6	2.3	100
AE55094	●	12 - 10	.187	21.5	10	7.8	1.8	100
AE55096	●	12 - 10	.250	24	11	9.6	3.5	100
AE50436	●	12 - 10	.375	28.5	15	10.2	5.2	100

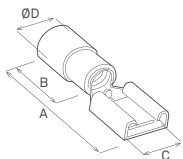

Terminal macho aislada (PVC)

Código	Color	Calibre	Serie	Dimensiones (mm)				Piezas
				A	B	C	ØD	
		AWG						
AE51242	●	22 - 16	.250	20.5	9.7	6.3	3.5	100
AE51201	●	16 - 14	.250	20.5	9.7	6.3	4	100
AE55121	●	12 - 10	.250	24.5	13.7	6.3	5.4	100

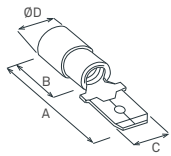

Terminal tipo punta aislada (PVC)

Código	Color	Calibre	Dimensiones (mm)				Piezas
			A	B	C	ØD	
		AWG					
AE65143	●	22 - 16	27.7	10.7	2	4	100
AE65075	●	16 - 14	27.7	10.7	2	4.5	100
AE65085	●	12 - 10	27.2	13.7	2.7	6.3	100

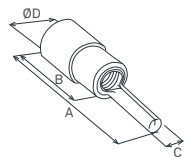

Tabla comparativa para terminales

Tamaño del barreno		Diámetro en pulgadas	Diámetro de las terminales en pulgadas	Tamaño del barreno		Diámetro en pulgadas	Diámetro de las terminales en pulgadas
Tornillo No.	Métrico			Tornillo No.	Métrico		
No. 0		.060	.064				
No. 1		.073	.077				
No. 2	M2	.086	.090	3/4"		.750	.776
No. 3		.099	.103				
No. 4		.112	.116				
No. 5	M3	.125	.129				
No. 6	M3.5	.138	.142	7/18"	M22	.875	.901
No. 8	M4	.164	.168				
No. 10		.190	.194				
No. 12		.216	.220				
No. 14		.242	.247	1"		1.000	1.026
1/4"	M6	.250	.260				
5/16"	M8	.312	.323				
3/8"		.375	.385	1 1/8"		1.125	1.151
7/16"		.437	.448				
1/2"	M12	.500	.510				
5/8"	M16	.625	.651	1 1/4"		1.250	1.276